

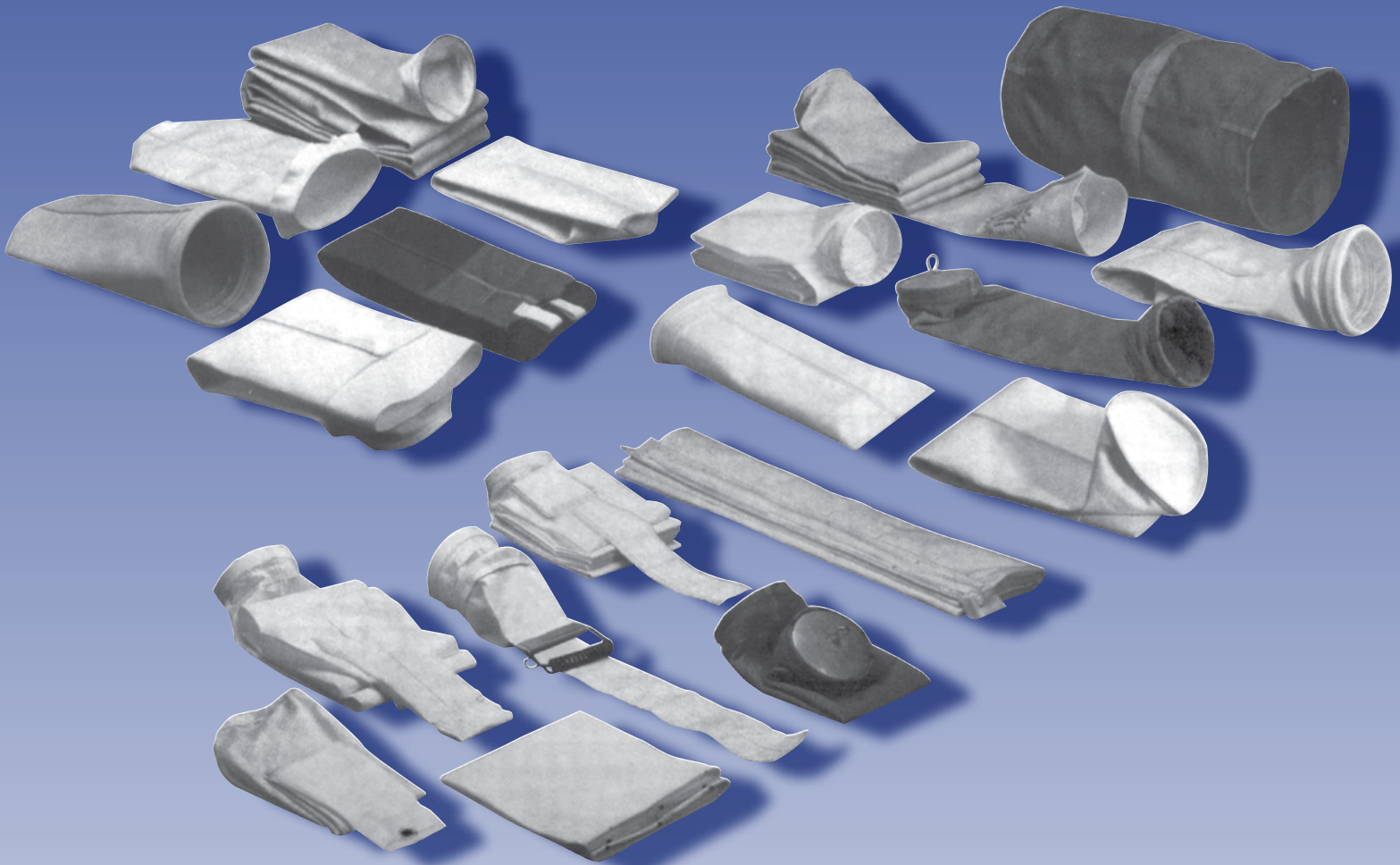

DUST FILTRATION



773-523-7200

OEM Filter Bag Manufacturer

7200 S Leamington Ave. Bedford Park, IL 60638 / Tel 773-523-7200 / Fax 773-523-7672

sales@filter-technology.com / www.filter-technology.com

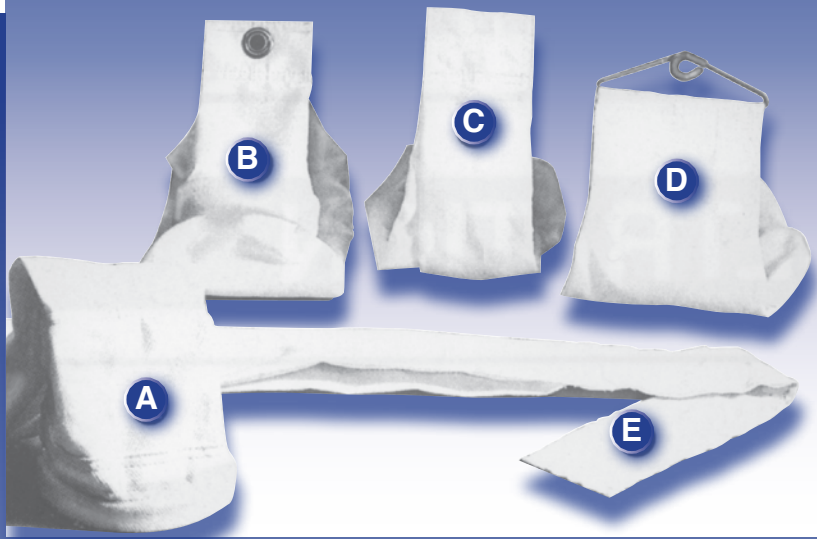

- (A) Wear resistant boot protects bag bottom
- (B) Loop top with grommet
- (C) Loop tapered top
- (D) Coiled loop hanger for special hanging
- (E) Strap top design

Available Dust Collector Bag Designs

TOPS

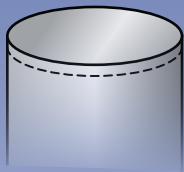

Disc Top

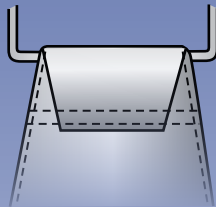

Looped Top

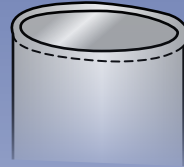

Open Top
with Cord

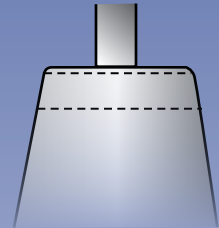

Strapped Top

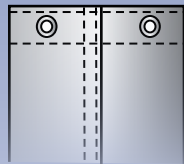

Flat Top
with Grommets

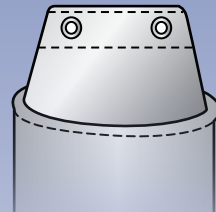

Top with Spreader
and Grommets

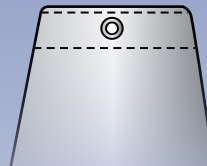

Tapered Top
and Grommet

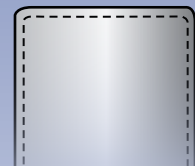

Flat Top

BOTTOMS

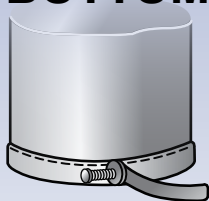

Screw Clamp Bottom



Raw Edge Bottom

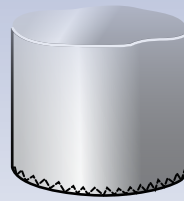

Overcast Edge Bottom

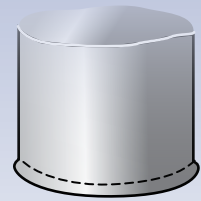

Corded Bottom



Sewn-In Steel
Snap Band

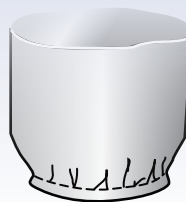

Sewn-In Spring

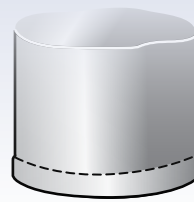

Hemmed Bottom

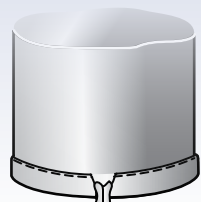

Sewn-In Tie Cord

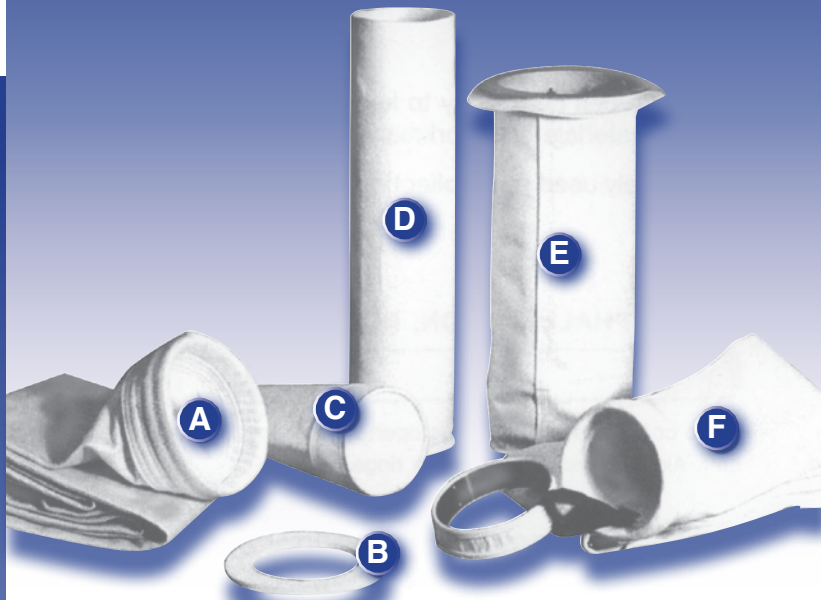

- A** Snapband leakfree seal
- B** Felt seal
- C** Wear resistant boot protects bag top
- D** Raw edge top bag
- E** Flange top bag for leak free operation
- F** Snapband replacement bag

Basic Fiber Qualities

Please consult us for specific information

FIBER	Maximum Continuous Operating Temperature °F	Acid Resistance	Alkali Resistance	Flex Abrasion	Support Combustion	Special Properties
Cotton	180	POOR	EXCELLENT	GOOD	YES	Low cost - Can be treated for flame retardants
Polyester	300	GOOD	FAIR	GOOD	YES	Degradation may occur in hot, humid conditions
Acrylic Homopolymer	285	GOOD	FAIR	GOOD	YES	An acrylic, but higher temperature applications
Glass	550	FAIR	POOR	POOR	NO	Finishes limit maximum temperature range
Nylon	300	POOR	EXCELLENT	EXCELLENT	YES	Excellent tensile strength and flex life
Polypropylene	200	EXCELLENT	EXCELLENT	EXCELLENT	YES	Excellent cake release
Nomex® / Conex®	400	FAIR	EXCELLENT	GOOD	NO	High temperature
Teflon®	450	EXCELLENT	EXCELLENT	FAIR	NO	Excellent chemical resistance

Standard Dust Collector Bags and Tubes

(These and Many Others)

Count on Filter Technology Inc. to supply the replacement bags and tubes necessary to keep your dust collection system operation at peak efficiency; and be assured our standards for quality materials and workmanship are unsurpassed.

Following are drawings of standard bags and tubes for some of the widely used dust collecting systems; both shaker, reverse air, and pulse jet.

American Air Filter Basic Construction: Open both ends. Endless extension coil spring ring inserted in each cuff.



American Wheelabrator, Pangborn, etc. Basic Construction: Hem top, strap top, or open top for cap. Steel band spring ring or rope in cuff. Also offered with spreader rings.

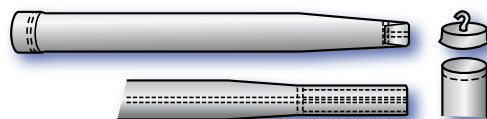

Carter Day, Mikro-Puls, Flex-Kleen, Kice, Fuller Plenum-Pulse, ICS, Norfelt Basic Construction: Most tubes are made of needled synthetic felt and have a disc sewn in one end, with the other end open. Available with or without braided ground wire.

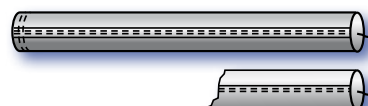

Dracco Basic Construction: Single or compartmented tubes (v-top, multiple he top, or open hanger tunnel).

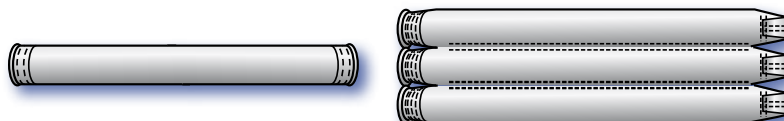

Fuller Airveyor Basic Construction: One end with a rope inserted in a double cuff. Other end closed by sewing in a disc with a hole in center. Spreader ring(s) sewn to outside of tube.



Norblo, Halliburton, Buhler Basic Construction: Both ends open with a rope inserted in a double cuff. Also offered with spreader rings.



Pangborn, Aggregates Equipment Basic Construction: Single- or multi-compartment bag. Close cell sponge neoprene cord in bottom hem, silicone sponge rubber for high-temperature application.

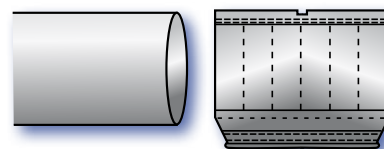

Parsons Basic Construction: Open at one end, with either a rope in the cuff or an endless extension coil wire spring inserted. Other end formed to a hem top. Available with or without an oblong metal ring sewn to the outside, near the closed end, and with or without braided ground wire.



Sly Basic Construction:

A) EE or ED—35" x 43-1/2". Single-compartment bag with 33-1/2" metal rod inserted in each hem. Three holes in bottom of bag, seven holes in hem, and one hole in each "ear".

B) Resist-O-Wear—35" x 46-3/4". Three-compartment bag similar in construction to Type EE and ED, except for addition of a "false" bottom for inserting a mullion, and stitching for compartments.

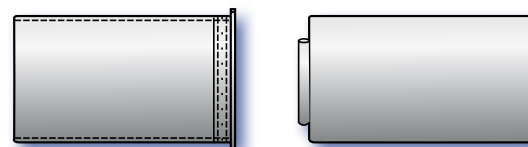

Western Precipator, American Wheelabrator, Dracco, etc. (high-temperature) Basic construction: Both ends with rope or spring steel band inserted in double cuff, also with spreader rings sewn to the outside of the tube.



Disclaimer of Warranty To the best of our knowledge, the data contained in this publication is correct; however, we do not assume any liability for the accuracy or completeness of the information. Users should perform their own tests to determine final suitability. Final determination of the suitability of any information or product for the use contemplated by any user, the manner of that use, and whether there is any infringement of patents is the sole responsibility of the user.